

TGEP

Configure Manual

www.tgeponline.com/cs

TGEP Add-on / Networks

TGEP Version 1.1.16

June 5th, 2016

TGEP

840 Brian Dr, Suite A

Crest Hill, IL – 60403

630-847-1421

www.tgeponline.com/cs

sales@tgeponline.com

Table Of Contents

	Table of Contents.....	3
Chapter 1	Introduction.....	4
Chapter 2	Date & Time.....	5
Chapter 3	CSSiteID.....	6
Chapter 4	Commercial.....	6
Chapter 5	CS Zone.....	7
Chapter 6	Network Setup.....	8
Chapter 7	Manual IP Address.....	9
Chapter 8	AWS Test.....	9
Chapter 9	Thanks.....	10

Introduction

Thanks for buying the add-on module for your charging station. The next couple of pages will guide you through the configuration pages. The add-on module including the software is in beta phase so we would ask you to be patient with us if you encounter any bugs during the process. Please report the bugs at your earliest convenience. You will encounter the TGEF CS Customer/Dealer Setup screen when you turn on the CS for the first time, you should be seeing the screen below. This screen is only for CS Owners/Property Managers or dealers configuring the unit. Please have the order form and a smart phone ready with you while you configure this app. The configuration is done the first time you start the system. Once you configure the system it goes to the main application and you will not see this screen again. Approximate time for configuration is about 10 minutes.



Please Note : If you don't see this screen when you turn the system on and are noticing some unusual messages please refer to the FAQ section in on our website www.tgeponline.com/cs

Date

Set the date in the format of (mm/dd/yyyy). Since all reports, income calculation etc are generated on the date/time configured by the customer. TGEF is not responsible for any date/time mismatch with the servers. Click next to go to next page.

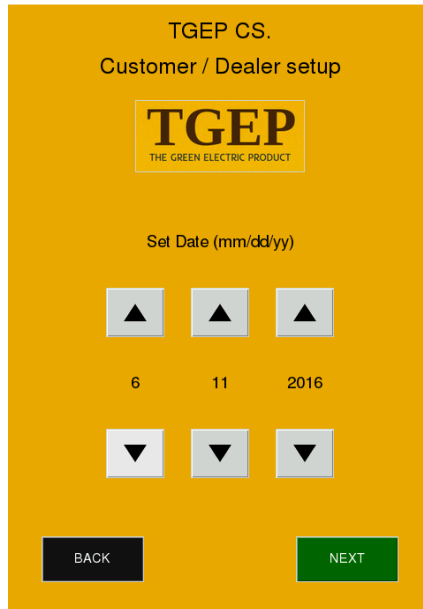

TGEF CS.
Customer / Dealer setup

TGEF
THE GREEN ELECTRIC PRODUCT

Set Date (mm/dd/yy)

▲ ▲ ▲

6 11 2016

▼ ▼ ▼

BACK NEXT

Time

Set the machine as per your local time. Click next to go to the next screen.

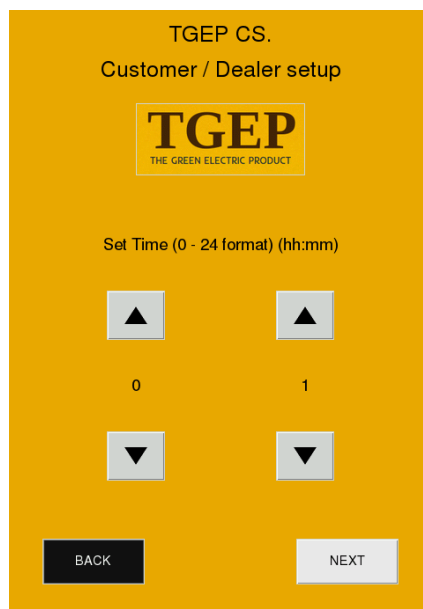

TGEF CS.
Customer / Dealer setup

TGEF
THE GREEN ELECTRIC PRODUCT

Set Time (0 - 24 format) (hh:mm)

▲ ▲

0 1

▼ ▼

BACK NEXT

CSSiteID

CSSiteID is a unique number under network charging given to a charging station. No two stations can have the same ID number. This unique id is generated automatically during the purchase of the product. Please refer to the email receipt of the purchase order. This receipt will indicate the CSSiteID on it. Please match the CSSiteID with the email receipt of the purchase order. If it doesn't match please stop the configuration process and inform us immediately.

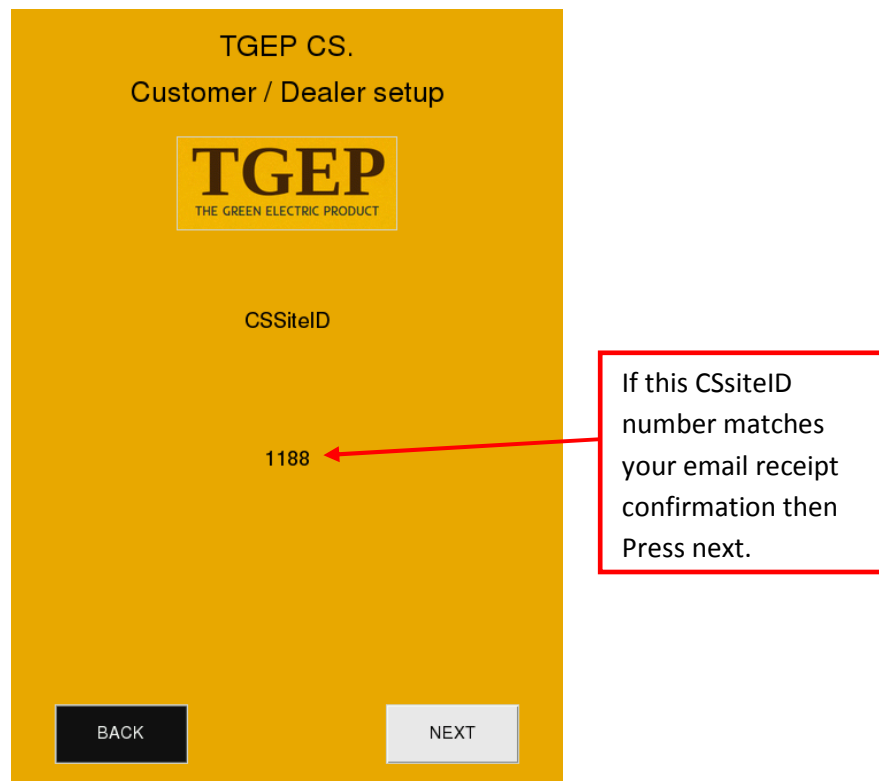

We maintain a very close monitor of the CSSiteID numbers and the IP address of the location. If there are any changes to the IP address we will red flag it till we get a confirmation from the owner of the charging station. TGEF has to be notified in case of a re-sale of charging stations add-on modules. In case of a re-sale of the module or cs with modules the customer setup application has to be executed again. A copy of the "bill of sale" needs to given to TGEF for the sales division to reconfigure the customer setup again. TGEF will implement addition necessary security protocols in the future regarding transfer of ownership and use of network system.

Commercial

If you order for a commercial charging station or module it will say yes or no. A commercial charging station generates income for the owner. Please refer to the email receipt of the purchase order to verify

if you ordered a commercial station or not. The service charges for the commercial stations are \$99/per year per station.

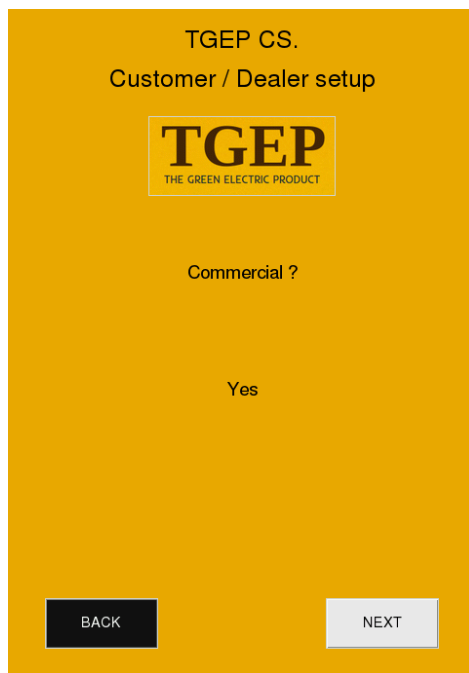

CS Zone

Every charging station is allocated a zone during configuration. This zone is automatically assigned by the system. Please refer to email receipt of the purchase order to verify it's the correct zone.

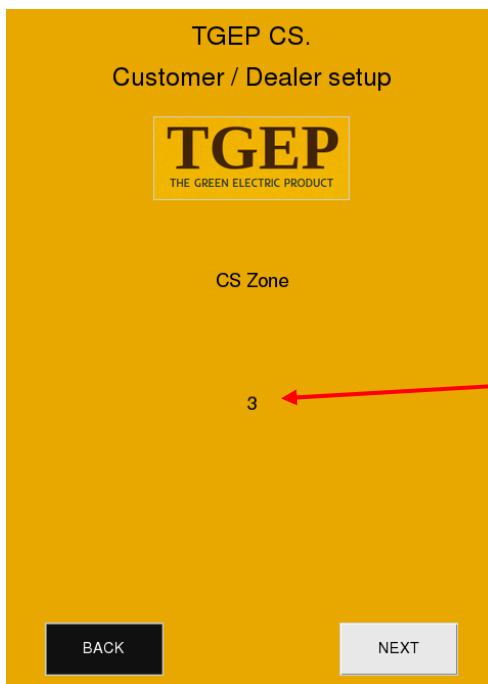

If this CS Zone number matches your email receipt confirmation then Press next.

Network Setup

The network setup is a crucial part of the configuration of the charging station. The charging station has to be connected to the internet all the time. TGEP uses (AWS) Amazon Web Services for its computing process. You can connect the charging station to a network either using a Cat 5e / 6 cable or a Wi-Fi Adapter. If you have connected the add-on module with cat 5e/6 cable then click on the LAN/Ethernet icon. If you are using a Wi-Fi adapter click on the WLAN/Wifi icon.

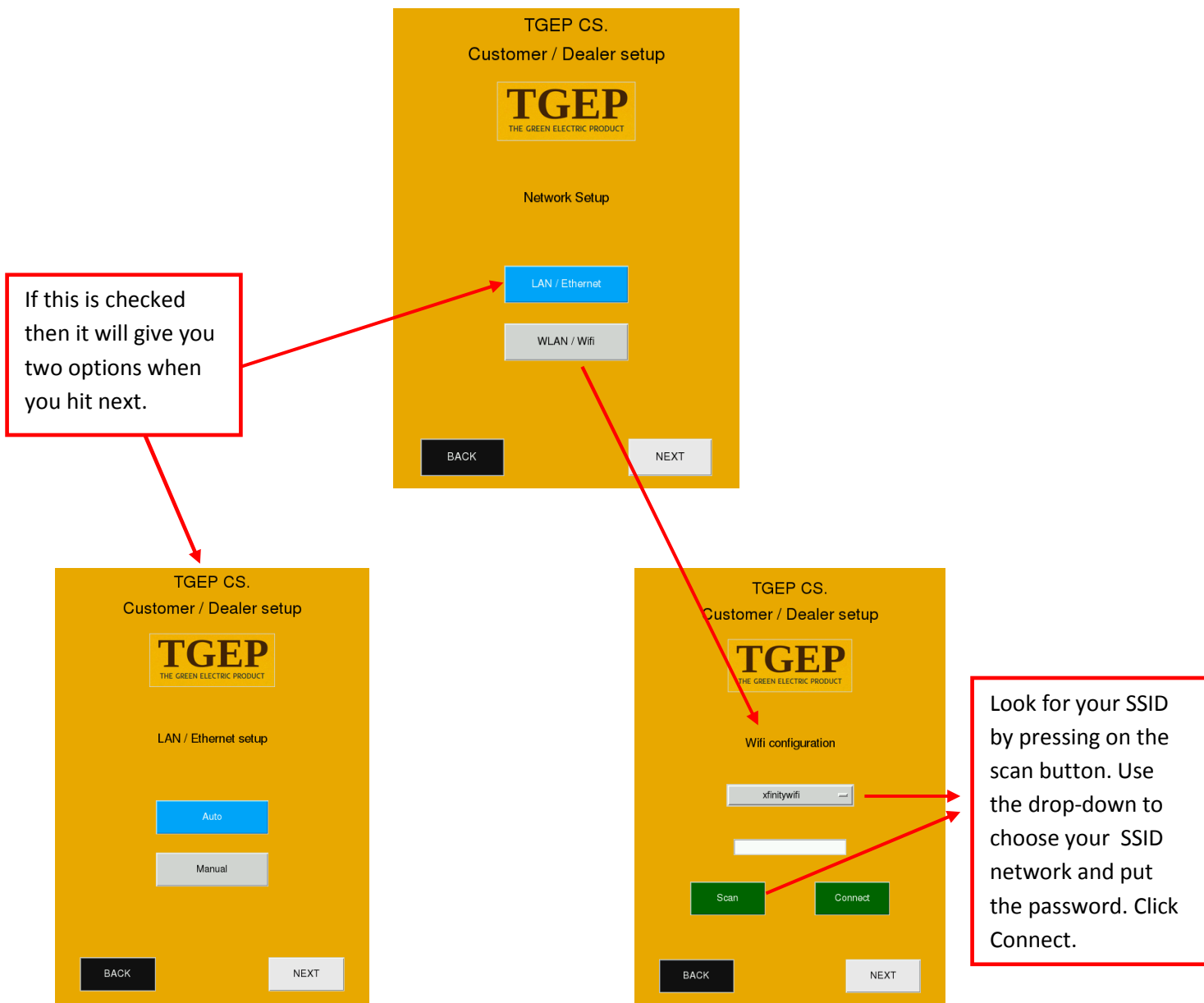

Click "Auto" in Lan/Ethernet setup for automatically configuring to the existing network.

Manual IP Address

Type the IP address you want to assign to the system with subnet mask and the default gateway address. You seriously need to know what you are doing here. Assigning an improper IP or the one out of range means your charging station cannot use network and cannot be connected to internet. Click next. will configure the station network to your network setting which you have assigned.



The screenshot shows a yellow background with the following text and elements:

- Header: TGEV CS. Customer / Dealer setup
- Logo: TGEV THE GREEN ELECTRIC PRODUCT
- Section: LAN / Ethernet setup
- Form fields: IP Address, Subnet Mask, and Gateway IP, each with a white input box.
- Buttons: A black 'BACK' button and a grey 'NEXT' button at the bottom.

AWS Test

Click on "Test AWS" to check the cloud connection to the system. The system is connected to the Amazon Web Service and is supported by AWS firewall.



The screenshot shows a yellow background with the following text and elements:

- Header: TGEV CS. Customer / Dealer setup
- Logo: TGEV THE GREEN ELECTRIC PRODUCT
- Section: AWS Test
- Status: Test OK. Proceed.
- Button: A white 'TEST AWS' button.
- Buttons: A black 'BACK' button and a green 'NEXT' button at the bottom.

Thanks

The big thank you for buying our product & supporting our small business. We appreciate if you could give some feedbacks and positive reviews on our product. Also feel free to email us concerns and improvements which could be done on the product.

